



HOMCUBE

---

HOME REDEFINED

FOR HOUSING ADVOCATES, THE ARCHITECTURAL COMMUNITY AND URBAN POLICY MAKERS, HOMCUBE IS A MEDLEY OF THEMES: THE CHANGING DEMOGRAPHIC OF CITIES WITH INADEQUATE HOUSING; A CULTURE EAGER TO MAKE A SMALLER ENVIRONMENTAL FOOTPRINT BY PARING DOWN BELONGINGS AND SHARING RESOURCES; AND WHAT HAS BECOME A SCARCITY ...AFFORDABLE HOUSING.

HOMCUBE CORPORATE OFFICE

23 CORPORATE PLAZA, NEWPORT BEACH, CA.92660

TELEPHONE 949.629.2553



## Endless Possibilities

HOMCUBE is a modern alternative for corporate housing, university dormitories, travel and leisure rental properties -- and much more. We can deliver an innovative modular home solution to organizations grappling with needs for temporary or long-term accommodations.

With HOMCUBE's modular home format, property developers and housing specialists can design flexible, turnkey communities. Our docking stations are streamlined and efficient, with gas, power and water all integrated from one location. New HOMCUBE units are designed for easy one-click connection to the docking station module.

Three-high complex allows for the option of ground floor 'work' and upper level 'living' conditions, or ground floor ADA living modules.

The two-high complex allows for three parking spaces



HOMCUBE is not limited by the bounds of the docking station. Single modules make for ideal auxiliary housing. Optional upgrades would include selection of exterior cladding color, as well as decorative screen panels.

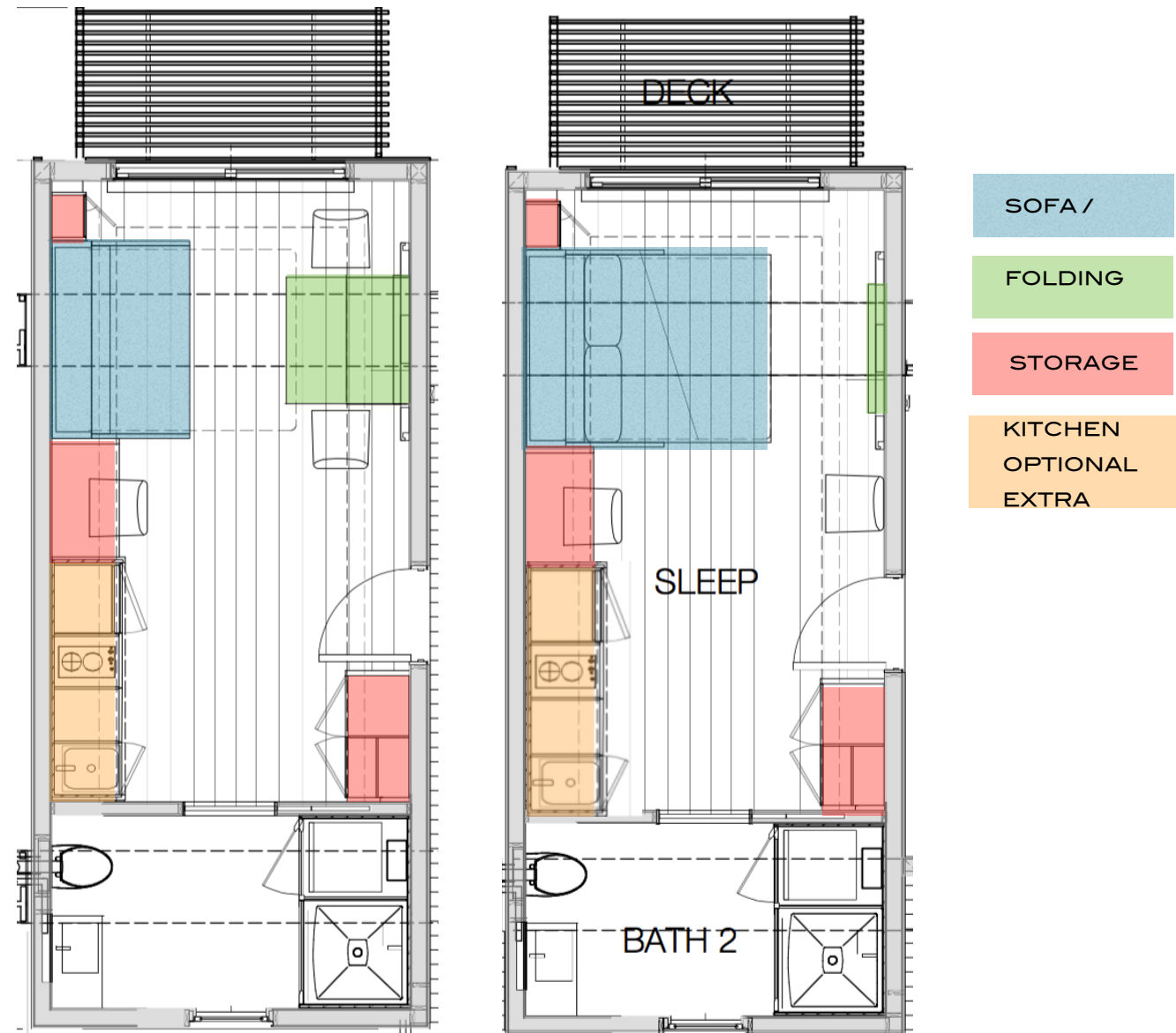

### Living large in a compact plan

Each HOMCUBE is a 300-square-foot modular unit that can be combined with additional cubes to address your lifestyle needs. With multiple configuration options and customizable design selections, HOMCUBE offers a versatile and stylish next-generation home alternative.

From the all-in-one studio plan, to multi-cube configurations for add-on bedroom, living room/kitchen and office space, the modular format of HOMCUBE allows you to live comfortably in a single unit or combine units to build your ideal home.

## LARGER LIVING IN A COMPACT PLAN

TWO STUDIO CUBES ARE CONNECTED WITH THE UPGRADE 'FOYER MODULE'  
CREATING A ONE BEDROOM HOME WITH SEPARATE BEDROOM AND LIVING AREAS

### STUDIO CUBE

The studioCube artfully integrates life's necessities into an innovative all-in-one floorplan. With a kitchen, bathroom, workstation, living space and fold-away, king-sized bed, the studioCube offers function and style in a tidy 250-square-feet.

### LIVE SLEEP DUO CUBE

The Live-Sleep duoCube provides separate living and sleeping spaces, with one cube offering living, cooking and dining space with bathroom, while the other cube offers a master bedroom and bathroom.



### DUO CUBE

For roommates, families or anyone who needs multiple living and sleeping spaces, the duoCube floorplan combines two studioCubes connected by a foyer, creating a fully-equipped two-bedroom, two-bathroom HOMCUBE.

### LIVE / WORK

No need to take your work home at night or host meetings in your kitchen. The Live-Work duoCube neatly separates your home life and work life, offering a cube fully outfitted for living and a second cube configured as a workspace.

Each deck designed with generous 5'-0" wide walkways.

Stairs and walkway surfaces are environmentally friendly composite wood planks set on steel framing.





### **Modern Technology.**

### **Artful Interiors.**

### **A New Way to Live.**

HOMCUBE incorporates everything you need — and nothing you don't — in a master-planned 300 square-foot space. With future-ready smart home amenities and high-end design features, HOMCUBE enables next-generation living at a lower cost than the average monthly rent payment.

Interiors are designed to maximize every square inch with uncompromising attention to detail and consideration to the comfort and lifestyle of each owner.

Standard features include fully furnished interiors including linen and window treatments, home automation, LED lighting, solar energy panels, all constructed with environmentally responsible materials.

Foldaway bed and sofa, desk and dining table, 50" TV, Kitchen with cooktop, refrigerator, sink, dishwasher and microwave; Bathroom with sink, wall hung toilet and unique shower with washer/dryer enclosure.



## Personalized home

With three available trims and a variety of color palettes, HOMCUBE offers customizable interior options to fit your personal style.

### Organic

Wood floors and wood paneled walls are set against high-gloss, white laminate with contrasting wood textures that complement the neutral and warm tones of the interior.

### Trend

High-gloss, white laminate cabinets and surfaces are framed by wood floors and wood paneled walls against a crisp white trim.

### Lux

Plush carpet flooring in multi-color designs contrast against paneled walls in high-gloss, white laminate and a crisp white trim.

